

# ELEVATION CERTIFICATE

OMB No. 1660-0008  
Expires March 31, 2012

Important: Read the instructions on pages 1-9.

## SECTION A - PROPERTY INFORMATION

A1. Building Owner's Name Kava Holdings, Inc.

A2. Building Street Address (including Apt., Unit, Suite, and/or Bldg. No.) or P.O. Route and Box No.  
701 Stone Canyon Road  
City Los Angeles State CA ZIP Code 90077

A3. Property Description (Lot and Block Numbers, Tax Parcel Number, Legal Description, etc.)  
Portion of Lot "I" of Bel-Air, MB 113-9.

Bureau of Engineering	
Permit No. <u>07016-16000-04281</u>	Reference Company Use: Elevation Certificate Review
<input checked="" type="checkbox"/> Approved	By: <u>MBA</u>
Date: <u>10-13-2011</u>	

A4. Building Use (e.g., Residential, Non-Residential, Addition, Accessory, etc.) Non-residential

A5. Latitude/Longitude: Lat. 34.0873 Long. -118.4469 Horizontal Datum:  NAD 1927  NAD 1983

A6. Attach at least 2 photographs of the building if the Certificate is being used to obtain flood insurance.

A7. Building Diagram Number 2

A8. For a building with a crawlspace or enclosure(s):

a) Square footage of crawlspace or enclosure(s) N/A sq ft

b) No. of permanent flood openings in the crawlspace or enclosure(s) within 1.0 foot above adjacent grade N/A

c) Total net area of flood openings in A8.b N/A sq in

d) Engineered flood openings?  Yes  No

A9. For a building with an attached garage:

a) Square footage of attached garage N/A sq ft

b) No. of permanent flood openings in the attached garage within 1.0 foot above adjacent grade N/A

c) Total net area of flood openings in A9.b N/A sq in

d) Engineered flood openings?  Yes  No

## SECTION B - FLOOD INSURANCE RATE MAP (FIRM) INFORMATION

B1. NFIP Community Name & Community Number  
City of Los Angeles - 060137

B2. County Name  
Los Angeles

B3. State  
California

B4. Map/Panel Number <u>060137C1580</u>	B5. Suffix <u>F</u>	B6. FIRM Index Date <u>9/26/2008</u>	B7. FIRM Panel Effective/Revised Date <u>9/26/2008</u>	B8. Flood Zone(s) <u>AO</u>	B9. Base Flood Elevation(s) (Zone AO, use base flood depth) <u>533.80' (depth 2 feet)</u>
--	------------------------	---	---	--------------------------------	--

B10. Indicate the source of the Base Flood Elevation (BFE) data or base flood depth entered in Item B9.  
 FIS Profile  FIRM  Community Determined  Other (Describe) \_\_\_\_\_

B11. Indicate elevation datum used for BFE in Item B9:  NGVD 1929  NAVD 1988  Other (Describe) \_\_\_\_\_

B12. Is the building located in a Coastal Barrier Resources System (CBRS) area or Otherwise Protected Area (OPA)?  Yes  No  
Designation Date \_\_\_\_\_  CBRS  OPA

## SECTION C - BUILDING ELEVATION INFORMATION (SURVEY REQUIRED)

C1. Building elevations are based on:  Construction Drawings\*  Building Under Construction\*  Finished Construction  
\*A new Elevation Certificate will be required when construction of the building is complete.

C2. Elevations - Zones A1-A30, AE, AH, A (with BFE), VE, V1-V30, V (with BFE), AR, AR/A, AR/AE, AR/A1-A30, AR/AH, AR/AO. Complete Items C2.a-h below according to the building diagram specified in Item A7. Use the same datum as the BFE.  
Benchmark Utilized 13-17392 Vertical Datum NGVD 29  
Conversion/Comments \_\_\_\_\_

Check the measurement used.

a) Top of bottom floor (including basement, crawlspace, or enclosure floor) 526.23  feet  meters (Puerto Rico only)

b) Top of the next higher floor 535.23  feet  meters (Puerto Rico only)

c) Bottom of the lowest horizontal structural member (V Zones only) N/A  feet  meters (Puerto Rico only)

d) Attached garage (top of slab) N/A  feet  meters (Puerto Rico only)

e) Lowest elevation of machinery or equipment servicing the building (Describe type of equipment and location in Comments) 530.36  feet  meters (Puerto Rico only)

f) Lowest adjacent (finished) grade next to building (LAG) 529.95  feet  meters (Puerto Rico only)

g) Highest adjacent (finished) grade next to building (HAG) 531.80  feet  meters (Puerto Rico only)

h) Lowest adjacent grade at lowest elevation of deck or stairs, including structural support 530.31  feet  meters (Puerto Rico only)

## SECTION D - SURVEYOR, ENGINEER, OR ARCHITECT CERTIFICATION

This certification is to be signed and sealed by a land surveyor, engineer, or architect authorized by law to certify elevation information. I certify that the information on this Certificate represents my best efforts to interpret the data available. I understand that any false statement may be punishable by fine or imprisonment under 18 U.S. Code, Section 1001.

Check here if comments are provided on back of form. Were latitude and longitude in Section A provided by a licensed land surveyor?  Yes  No

Certifier's Name Thomas P. Pilarski License Number CALS 8732

Title Land Surveyor Company Name Psomas

Address 28480 Avenue Stanford, #200 City Santa Clarita State CA ZIP Code 91355

Signature [Signature] Date 10/13/2011 Telephone 661.219.6000

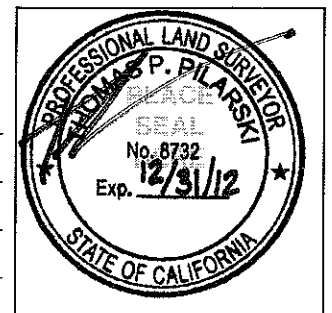

<b>IMPORTANT: In these spaces, copy the corresponding information from Section A.</b>	For Insurance Company Use:
Building Street Address (including Apt., Unit, Suite, and/or Bldg. No.) or P.O. Route and Box No. 701 Stone Canyon Road	Policy Number
City Los Angeles State CA ZIP Code 90077	Company NAIC Number

**SECTION D - SURVEYOR, ENGINEER, OR ARCHITECT CERTIFICATION (CONTINUED)**

Copy both sides of this Elevation Certificate for (1) community official, (2) insurance agent/company, and (3) building owner.

Comments See attached sketch for the general location of the building on the property.

C2e. - Elevator accessible to exterior of building. Elevation at finished grade along southern face of bldg.

Signature  Thomas P. Pilarski

Date 10/13/2011

Check here if attachments

**SECTION E - BUILDING ELEVATION INFORMATION (SURVEY NOT REQUIRED) FOR ZONE AO AND ZONE A (WITHOUT BFE)**

For Zones AO and A (without BFE), complete Items E1-E5. If the Certificate is intended to support a LOMA or LOMR-F request, complete Sections A, B, and C. For Items E1-E4, use natural grade, if available. Check the measurement used. In Puerto Rico only, enter meters.

- E1. Provide elevation information for the following and check the appropriate boxes to show whether the elevation is above or below the highest adjacent grade (HAG) and the lowest adjacent grade (LAG).
- a) Top of bottom floor (including basement, crawlspace, or enclosure) is 5.57  feet  meters  above or  below the HAG.
- b) Top of bottom floor (including basement, crawlspace, or enclosure) is 3.72  feet  meters  above or  below the LAG.
- E2. For Building Diagrams 6-9 with permanent flood openings provided in Section A Items 8 and/or 9 (see pages 8-9 of Instructions), the next higher floor (elevation C2.b in the diagrams) of the building is N/A  feet  meters  above or  below the HAG.
- E3. Attached garage (top of slab) is N/A  feet  meters  above or  below the HAG.
- E4. Top of platform of machinery and/or equipment servicing the building is 1.44  feet  meters  above or  below the HAG.
- E5. Zone AO only: If no flood depth number is available, is the top of the bottom floor elevated in accordance with the community's floodplain management ordinance?  Yes  No  Unknown. The local official must certify this information in Section G. N/A

**SECTION F - PROPERTY OWNER (OR OWNER'S REPRESENTATIVE) CERTIFICATION**

The property owner or owner's authorized representative who completes Sections A, B, and E for Zone A (without a FEMA-issued or community-issued BFE) or Zone AO must sign here. *The statements in Sections A, B, and E are correct to the best of my knowledge.*

Property Owner's or Owner's Authorized Representative's Name

Thomas P. Pilarski

Address 28480 Avenue Stanford, Suite 200

City Santa Clarita

State CA

ZIP Code 91355

Signature 

Date 10/13/2011

Telephone 661.219.6000

Comments

Check here if attachments

**SECTION G - COMMUNITY INFORMATION (OPTIONAL)**

The local official who is authorized by law or ordinance to administer the community's floodplain management ordinance can complete Sections A, B, C (or E), and G of this Elevation Certificate. Complete the applicable item(s) and sign below. Check the measurement used in Items G8 and G9.

- G1.  The information in Section C was taken from other documentation that has been signed and sealed by a licensed surveyor, engineer, or architect who is authorized by law to certify elevation information. (Indicate the source and date of the elevation data in the Comments area below.)
- G2.  A community official completed Section E for a building located in Zone A (without a FEMA-issued or community-issued BFE) or Zone AO.
- G3.  The following information (Items G4-G9) is provided for community floodplain management purposes.

G4. Permit Number	G5. Date Permit Issued	G6. Date Certificate Of Compliance/Occupancy Issued
-------------------	------------------------	---

G7. This permit has been issued for:  New Construction  Substantial Improvement

G8. Elevation of as-built lowest floor (including basement) of the building: \_\_\_\_\_  feet  meters (PR) Datum \_\_\_\_\_

G9. BFE or (in Zone AO) depth of flooding at the building site: \_\_\_\_\_  feet  meters (PR) Datum \_\_\_\_\_

G10. Community's design flood elevation \_\_\_\_\_  feet  meters (PR) Datum \_\_\_\_\_

Local Official's Name	<b>Bureau of Engineering</b> <b>Stormwater Group</b> <b>Elevation Certificate Review</b>  Permit No. <u>07010-10000-04281</u> <input checked="" type="checkbox"/> Approved By: <u>MBA</u> Date: <u>10/13/2011</u>	Title
Community Name		Telephone
Signature		Date
Comments		

Check here if attachments

# Building Photographs

See Instructions for Item A6.

Building Street Address (including Apt., Unit, Suite, and/or Bldg. No.) or P.O. Route and Box No. 701 Stone Canyon Road	For Insurance Company Use:
	Policy Number
City Los Angeles State CA ZIP Code 90077	Company NAIC Number

If using the Elevation Certificate to obtain NFIP flood insurance, affix at least two building photographs below according to the instructions for Item A6. Identify all photographs with: date taken; "Front View" and "Rear View"; and, if required, "Right Side View" and "Left Side View." If submitting more photographs than will fit on this page, use the Continuation Page, following.

## South Elevation

Date of Photograph - October 5, 2011



# Building Photographs

Continuation Page

Building Street Address (including Apt., Unit, Suite, and/or Bldg. No.) or P.O. Route and Box No. 701 Stone Canyon Road	For Insurance Company Use: Policy Number
City Los Angeles State CA ZIP Code 90077	Company NAIC Number

If submitting more photographs than will fit on the preceding page, affix the additional photographs below. Identify all photographs with: date taken; "Front View" and "Rear View"; and, if required, "Right Side View" and "Left Side View."

## East Elevation

Date of Photograph - October 5, 2011

