

**BOARD OF PUBLIC WORKS
MEMBERS**

CYNTHIA M. RUIZ
PRESIDENT

ANDREA A. ALARCÓN
VICE-PRESIDENT

PAULA A. DANIELS
PRESIDENT PRO TEMPORE

STEVEN T. NUTTER
COMMISSIONER

VALERIE LYNNE SHAW
COMMISSIONER

WILLIAM P. WEEKS
EXECUTIVE OFFICER

**CITY OF LOS ANGELES
CALIFORNIA**



ANTONIO R. VILLARAIGOSA
MAYOR

DEPARTMENT OF
PUBLIC WORKS

BUREAU OF
ENGINEERING

GARY LEE MOORE, P.E.
CITY ENGINEER

1149 S. BROADWAY, SUITE 700
LOS ANGELES, CA 90015-2213

<http://eng.lacity.org>

April 11, 2011

**NOTICE OF INTENT TO ADOPT A NEGATIVE DECLARATION FOR THE
OLYMPIC BOULEVARD AND MATEO STREET IMPROVEMENTS (W.O. E6000779)**

Pursuant to the State of California Public Resources Code Article 7 of the California Environmental Quality Act (CEQA), as amended, the City of Los Angeles Bureau of Engineering has prepared an Initial Study for the project described below. Under CEQA, the City identified no significant impacts and proposes to adopt a Negative Declaration.

Project Location: The proposed project is located on Olympic Boulevard between Mateo Street and Santa Fe Avenue and Mateo Street between Olympic Blvd. and Porter Street. The Los Angeles River is approximately 0.36 mile east of the project site.

Project Description: The proposed project consists of property acquisition and street widening. The City of Los Angeles proposes to widen westbound Olympic Boulevard between Mateo Street and Santa Fe Avenue for right turn lane, and northbound Mateo Street between Olympic Blvd. and Porter Street for increased curb return to improve freeway access. Prior to construction, the City would acquire and demolish the building at 2301-2303 Olympic Boulevard, APN 5167001038. The building to be acquired is currently not in use. The adjacent building located at 1530 – 1534 Mateo Street is currently being used as a fork lift repair and rental business. This structure will remain standing.

The project site is within the South Industrial Area and the Alameda Corridor Project, which is intended to facilitate access to the ports. The proposed project would improve access to the Santa Monica Freeway and thus improve traffic circulation along Olympic Blvd.

This notice is intended to give interested parties an opportunity to comment on the proposed project. The Initial Study is available for review at Little Tokyo Branch Library, 203 S. Los Angeles Street, Los Angeles, CA 90012 – Tel. (213) 612-0525. A copy of the Initial Study may also be obtained by contacting Catalina Hernandez of the Bureau of Engineering at (213) 485-5756 and can also be accessed online at <http://eng.lacity.org/techdocs/emg/>.

The 20-day public review period starts April 14 and ends May 5, 2011. **Comments must be received by May 5, 2011 in writing, by email to Catalina.Hernandez@lacity.org, or by mail to:**

City of Los Angeles Department of Public Works
Bureau of Engineering, EMG
Attn: Catalina Hernandez, Environmental Specialist
1149 S. Broadway, Suite 600
Los Angeles, CA 90015-2213

As a covered entity under Title II of the Americans with Disabilities Act, the City of Los Angeles does not discriminate on the basis of disability and, upon request, will provide reasonable accommodation to ensure equal access to its programs, services, and activities.



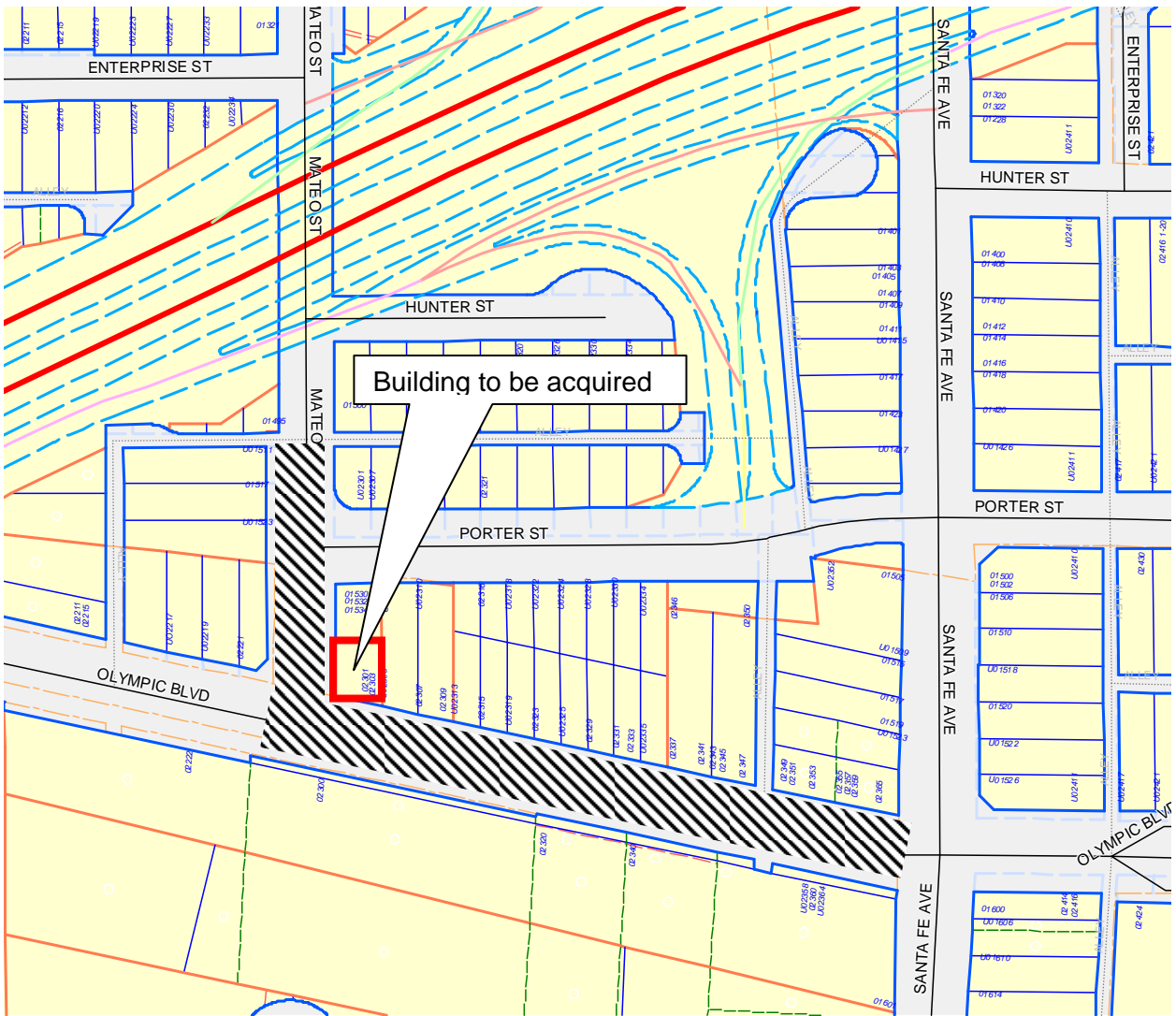

Figure1. Project Location - Street widening project area indicated by hatched areas.